

SEC. 25  
NORBECK  
SEC. 25 - T 120 N - R 70 W  
SCALE IN MILES

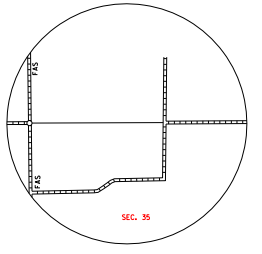

SEC. 35  
WECOTA  
SEC. 35 - T 120 N - R 69 W  
SCALE IN MILES

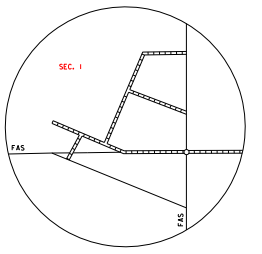

SEC. 1  
MIRANDA  
SEC. 1 - T 117 N - R 68 W  
SCALE IN MILES

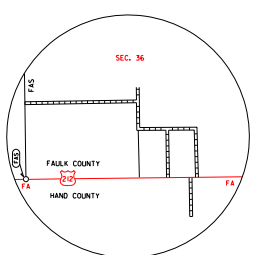

SEC. 36  
ZELL  
SEC. 36 - T 117 N - R 66 W  
SCALE IN MILES

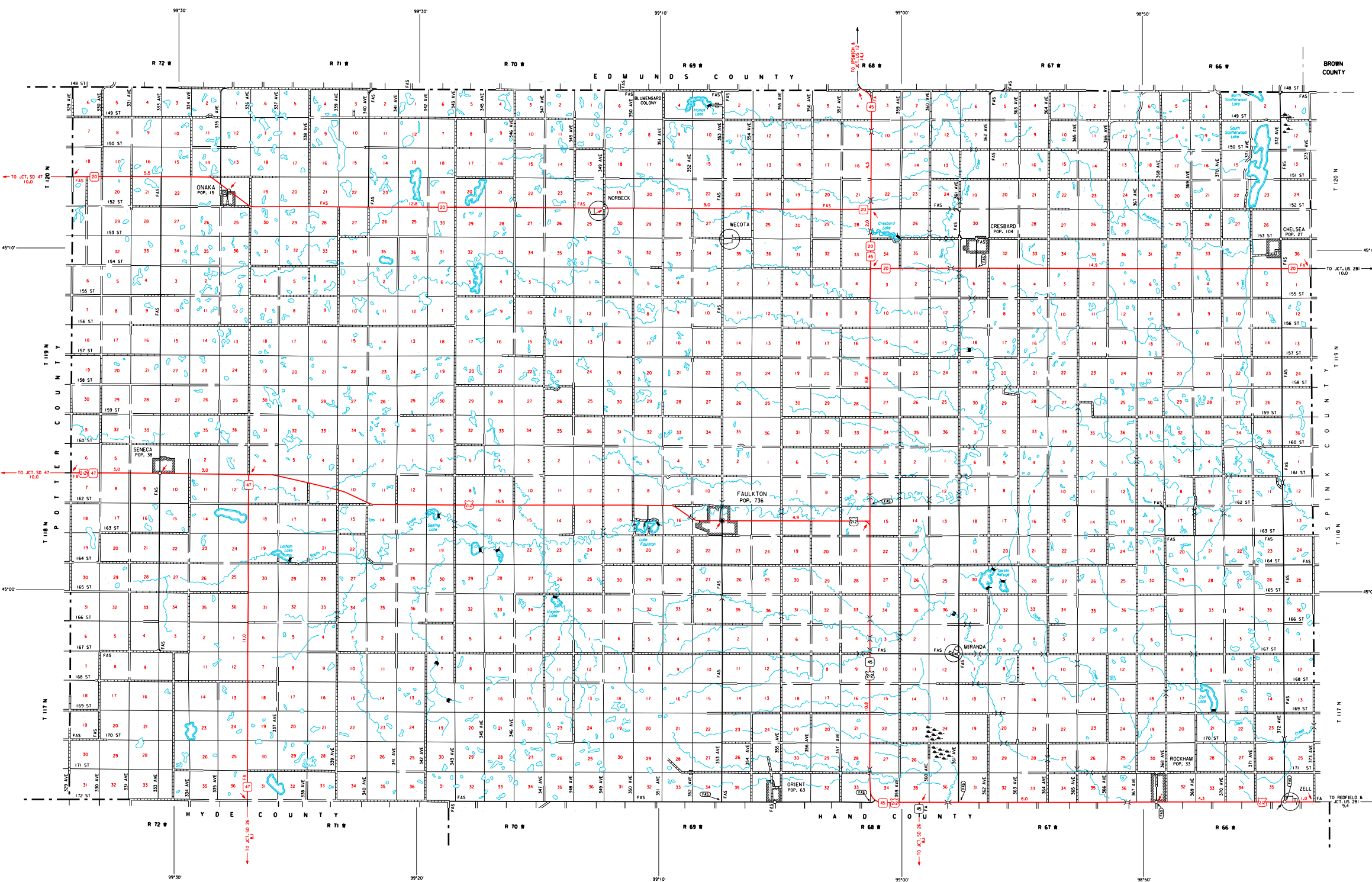

LEGEND

- INTERSTATE HIGHWAY (FULL CONTROL OF ACCESS)
- STATE NUMBERED HIGHWAY
- FEDERAL AID HIGHWAY SYSTEM
- FEDERAL AID SECONDARY HIGHWAY SYSTEM
- END OF FEDERAL AID DESIGNATED ROUTE
- PRIMITIVE ROAD
- UNIMPROVED ROAD
- GRADED OR DRAINED ROAD
- GRAVEL OR STONE SURFACED ROAD
- HARD SURFACED ROAD
- DIVIDED HIGHWAY (LEFT DRIVEWAY ROAD)
- INTERCHANGE
- ROADWAY GRADE SEPARATION
- POINTS BETWEEN BRIDGE SPANNES
- RAILROAD
- RAILROAD IN JURISDICTION
- RAILROAD CROSSINGS
- RAILROAD ABOVE
- RAILROAD BELOW
- AIRPORT WITH SURFACED RUNWAYS
- MILITARY FIELD
- ARROYO, COMPLETE FACILITIES
- ARROYO, LIMITED FACILITIES
- LANDING AREA OR STRIP
- INCLUDING PRIVATE AIR FIELDS
- ARMY LIGHT BEACON (GENERAL)
- NARROW STREAM
- WIDE STREAM (INTERMITTENT NAVIGATION)
- DRAINAGE DITCH (MAIN)
- IRRIGATION DITCH
- RESERVOIR, POND OR LAKE
- RESERVOIR, WITH DAM
- DAM
- WASH OR SWAMP LAND
- DOCK, PIER, OR LANDING
- HOBBS BRIDGE (OVER 20 FT. IN LENGTH)
- HOBBS BRIDGES CLOSELY SPACED
- STEEL TRUSS BRIDGE LARGE
- CANTILEVER BRIDGE
- FORD - ROAD ESTABLISHED
- CONCRETE FORD
- CAUSEWAY
- CATTLE GUARD
- PROMINENT ELEVATION
- STATE LINE
- COUNTY LINE
- CONGRESSIONAL TOWNSHIP LINE
- SECTION LINE
- FEDERAL AND STATE RECREATION ROADWAY LINE
- MONUMENT (SMALL)
- COUNTY SEAT
- OTHER CITIES AND VILLAGES
- UNINCORPORATED VILLAGE OR AREA OF CONGESTED CULTURE
- INCORPORATED CITY OR VILLAGE
- (FIGURES INDICATED 1990 POPULATION)

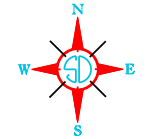

GENERAL HIGHWAY MAP  
**FAULK COUNTY**  
**SOUTH DAKOTA**

prepared by the  
SOUTH DAKOTA DEPARTMENT OF TRANSPORTATION  
in cooperation with the  
U.S. DEPARTMENT OF TRANSPORTATION  
FEDERAL HIGHWAY ADMINISTRATION

SCALE  
0 1 2 3 4 5 MILES

2016



UNIVERSAL TRANSVERSE MERCATOR PROJECTION

RESTRICTION OF LIABILITY: The South Dakota Department of Transportation makes no claim, promise or guarantee about the accuracy, completeness or timeliness of the data and information contained in this map. The user assumes all responsibility for any and all uses of the data and information contained in this map. The user agrees to hold the South Dakota Department of Transportation harmless from and against any and all claims, damages, losses and expenses, including reasonable attorneys' fees, that may be incurred by the user or any third party as a result of the use of the data and information contained in this map.

COPIES OF THIS MAP ARE AVAILABLE FOR PUBLIC USE AT A NOMINAL COST  
S.D. Department of Transportation  
Map Sale - Ph: (605) 773 5249  
P.O. Box 34000 - Pierre, South Dakota 57508