

LEGEND

| | | | |
|--|--|---|--|
| INTERSTATE HIGHWAY (FULL CONTROL OF ACCESS) | | NARROW STREAM | |
| U.S. NUMBERED HIGHWAY | | WIDE STREAM (PERMITMENT NAVIGATION) | |
| STATE NUMBERED HIGHWAY | | DRAINAGE DITCH (MAIN) | |
| FEDERAL AID HIGHWAY SYSTEM | | DRAINAGE DITCH (SMALL) | |
| FEDERAL AID SECONDARY HIGHWAY SYSTEM | | CONVEYER, POND OR LAKE | |
| END OF FEDERAL AID DESIGNATED ROUTE | | RESERVOIR, POND OR LAKE | |
| PRIMITIVE ROAD | | DAM | |
| UNIMPROVED ROAD | | MARSH OR SWAMP LAND | |
| GRAVEL AND GRAINED ROAD | | SOIL, PECK, OR LANDING | |
| GRAVEL OR STONE SURFACED ROAD | | HIGHWAY BRIDGE (OVER 20 FT. IN LENGTH) | |
| HARD SURFACED ROAD | | HIGHWAY BRIDGES CLOSELY SPACED | |
| DIVIDED HIGHWAY (WITH SHOULDER ROAD) | | STEEL TRUSS BRIDGE LARGE | |
| INTERCHANGE | | CONVEYER BRIDGE | |
| HIGHWAY GRADE SEPARATION | | FORD - ROAD ESTABLISHED | |
| POINTS BETWEEN WHICH DISTANCES ARE MEASURED INDICATED THIS | | CONCRETE FORD | |
| RAILROAD | | GRADEWAY | |
| RAILROAD IN JUNCTIFICATION | | CATTLE GUARD | |
| TWO OR MORE TRACKS OF SEPARATELY OPERATED COMPANIES ON ADJACENT RIGHT-OF-WAY | | PROMINENT ELEVATION | |
| RAILROAD CROSSINGS | | STATE LINE | |
| GRADE CROSSINGS | | COUNTY LINE | |
| RAILROAD ABOVE | | CONGRESSIONAL TOWNSHIP LINE | |
| RAILROAD BELOW | | SECTION LINE | |
| AIRPORT WITH SURFACED RUNWAYS | | FEDERAL AND STATE RECREATION BOUNDARY LINE | |
| MILITARY FIELD | | MONUMENT (SHRILL) | |
| AIRPORT, COMPLETE FACILITIES (COMMERCIAL OR MUNICIPAL) | | COUNTY SEAT | |
| AIRFIELD, LIMITED FACILITIES | | OTHER CITIES AND VILLAGES | |
| LANDING AREA OR STRIP, INCLUDING PRIVATE AIR FIELDS | | UNINCORPORATED VILLAGE OR AREA OF CONGESTED Dwellings | |
| AIRWAY LIGHT BEACON (GENERAL) | | UNINCORPORATED CITY OR VILLAGE | |
| | | TOWNSHIP INDICATED POPULATION | |

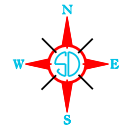

GENERAL HIGHWAY MAP
UNION COUNTY
SOUTH DAKOTA

prepared by the
 SOUTH DAKOTA DEPARTMENT OF TRANSPORTATION
 in cooperation with the
 U.S. DEPARTMENT OF TRANSPORTATION
 FEDERAL HIGHWAY ADMINISTRATION

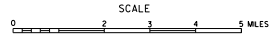

2016



UNIVERSAL TRANSVERSE MERCATOR PROJECTION

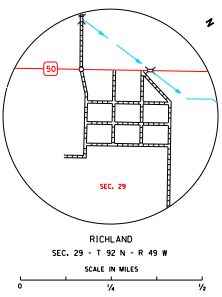

RESTRICTION OF LIABILITY: The South Dakota Department of Transportation makes no claim, promise or guarantee, either the accuracy, completeness or timeliness of the data and expressly disclaims liability for any and all damages or costs, including but not limited to the expenses of investigation of third party rights, title, merchantability and fitness for a particular purpose in connection with this data.

COPIES OF THIS MAP ARE AVAILABLE FOR PUBLIC USE AT A NOMINAL COST
 S.D. Department of Transportation
 Map Sales - (605) 773-5247
 Pierre, South Dakota 57501